

DEPARTMENT OF HAWAIIAN HOME LANDS
STATE OF HAWAII

May 28, 2013

ADDENDUM NO. 1

TO

PLANS, BID FORM, SPECIFICATIONS, CONTRACT AND BOND

FOR

**LALAMILO HOUSING PHASE 1
KAWAIHAE ROAD IMPROVEMENTS**

WAIMEA, SOUTH KOHALA, ISLAND OF HAWAII, HAWAII

IFB NO.: IFB-13-HHL-007

NOTICE TO ALL PROSPECTIVE BIDDERS

This addendum is hereby made a part of the PLANS, BID FORM, SPECIFICATIONS, CONTRACT AND BOND for the LALAMILO HOUSING PHASE 1, KAWAIHAE ROAD IMPROVEMENTS, WAIMEA, SOUTH KOHALA, ISLAND OF HAWAII, HAWAII, and it shall amend the said contract documents as detailed within this Addendum document.

APPROVED:

Jobie M. K. Masagatani, Chairman
Hawaiian Homes Commission

Date May 28, 2013

Please detach, execute, and return immediately, the receipt below, to the Department of Hawaiian Home Lands, P. O. Box 1879, Honolulu, HI 96805, or transmit facsimile to (808) 620-9299.

Receipt of Addendum No. 1 for the the LALAMILO HOUSING PHASE 1, KAWAIHAE ROAD IMPROVEMENTS, WAIMEA, SOUTH KOHALA, ISLAND OF HAWAII, HAWAII, is hereby acknowledged.

Signed _____

Title _____

Firm _____

Date _____

DEPARTMENT OF HAWAIIAN HOME LANDS
STATE OF HAWAII

May 28, 2013

ADDENDUM NO. 1

TO

PLANS, BID FORM, SPECIFICATIONS, CONTRACT AND BOND

FOR

**LALAMILO HOUSING PHASE 1
KAWAIHAE ROAD IMPROVEMENTS**

WAIMEA, SOUTH KOHALA, HAWAII

IFB NO.: IFB-13-HHL-007

PRE-BID MEETING

A mandatory Pre-bid meeting was held at the Department of Hawaiian Home Lands, West Hawaii District Office, on May 23, 2013. Meeting minutes and attendance sheet from the pre-bid meeting are attached to this addendum.

Meeting was conducted by Kevin Cavanagh, Construction Manager with SSFM.

Regarding agenda item "5. Proposal". Hawaii Products Preference SPO-38 due ~~Monday, May 27,~~ Tuesday, May 28, 2013, 9:00 a.m.

Regarding agenda item "7.a.: Plan approvals". As of the publication of this Addendum No. 1, the plans have not been approved yet by all agencies. Due to the time constraints for funding of this project, no addendum can be issued to replace the current plans with approved plans. Changes per agencies review after the bid opening will be by DHHL field directed changes.

Regarding agenda item "8.a. Substitution Requests" due by ~~Monday, May 27, 2013, 2:00 p.m.~~ Tuesday, May 28, 2013, 9:00 a.m.

Regarding agenda item "8.b. Hawaii Products Preference SPO-38" due ~~Monday, May 27, 2013, 2:00 p.m.~~ Tuesday, May 28, 2013, 9:00 a.m.

A non-mandatory site inspection was held after the meeting.

SUMMARY OF QUESTIONS AND RESPONSES

Questions were asked at the Pre-Bid meeting and Site Inspection

1. Q: What is the anticipated start date of the project?
A: The anticipated start of the project, subject to change, is late Summer/early Fall 2013.
2. Q: Has DOT approved the plans yet?
A: No, DOT has not yet signed off on the plans.
3. Q: Bid Item 3 (Relocate Hawaiian Telcom Telephone Poles) is shown as a Lump Sum item, shouldn't it be an Allowance item?
A: This will be addressed by the Engineer in forthcoming Addendum.
4. Q: Bid Item 41 (Manhole relocation work by Sandwich Isles Communications) is shown as a Lump Sum item, shouldn't it be an Allowance item?
A: This will be addressed by the Engineer in forthcoming Addendum.
5. Q: The pdf copy of the documents has some items which are hard to read, will they be corrected?
A: Yes, they will be corrected and issued in forthcoming addendum.
6. Q: Item 32 (Heavy equipment rental and/or costs, including delivery and hauling) does not specify what types of equipment, can this be clarified?
A: The Engineer will clarify in forthcoming Addendum.
7. Q: When is the existing gate shown on the Demolition Plan to be removed?
A: The removal of the existing gate shall be coordinated during construction.
8. Q: Is emergency egress to be provided through the gate during construction?
A: Yes, emergency egress will need to be provided.
9. Q: Items 11 (Asphalt Concrete Aggregate Base Course) and Item 12 (Asphalt Concrete Aggregate Subbase) state asphalt, does it mean Aggregate Base and Aggregate Subbase?
A: The Engineer will confirm this and advise in forthcoming Addendum.
10. Q: Some allowance items in the proposal form are missing dollar amounts. Will dollar amounts be provided?
A: The Engineer will provide the required allowance dollar amounts in forthcoming Addendum.
11. Q: Is a NPDES permit required?
A: Yes, the NPDES permit application has already been submitted but not approved.

CONTRACTOR'S SUBMITTALS-BID FORM

Delete pages 3 and 8 of the Bid Form and replace with new pages 3 and 8 Addendum No.1 Bid Form, attachment to this addendum.

CONSTRUCTION PLANS

Replace Sheets 9, 10, 11, and 13 with the attachment to this addendum:

Sheet 9 – PLAN AND PROFILE – KAWAIHAE ROAD STA. 454+10 TO 459+00
Sheet 10 – PLAN AND PROFILE – KAWAIHAE ROAD STA. 459+00 TO 464+00
Sheet 11 – PLAN AND PROFILE – KAWAIHAE ROAD STA. 464+00 TO 469+00
Sheet 13 – PLAN AND PROFILE - DRAINLINE

Electrical Drawings E-1, E-2, E-3, E-4, E-5: Delete any and all references for work to relocate existing underground Communications infrastructure for Sandwich Isles Communications, Inc. The existing underground Communications infrastructure will remain in place. A \$15,000 allowance was included to adjust the finish elevation of the cover for the affected existing Sandwich Isle Communications manhole to match the elevation of the new roadway. These sheets are not physically attached to this addendum but will be provided to the winning bidder.

QUESTIONS RECEIVED

1. Q: Will the Department consider accepting sealed bids at its neighbor island district offices?
A: No. Sealed bids must be delivered to DHHL Hale Kalanianaʻole Building, 91-5420 Kapolei Parkway, Kapolei, Hawaii 96707, as indicated in the Notice to Bidders Invitation for Bid, and explained at the 5/23/13 Pre-Bid Conference.
2. Q: What is the Engineer's estimate for this project?
A: The Department of Hawaiian Home Lands does not release the Engineer's estimate prior to Bid Opening.
3. Q: What is the anticipated jobsite start date for this project?
A: The estimated construction start date for this project, subject to change, is late summer/early fall 2013.
4. Q: Instructions for Bid Submittal, page 1 states that the Bid Offer Form needs to be notarized, is this correct?
A: Yes.
5. Q: Bid Offer Form, Item No. 3 shows "L.S." as the "No. of Units (Estimated)" but the description describes the item as being an "Allowance" item. Please clarify if Item No. 3 is a "Lump Sum" or "Allowance" item.
A: Item No. 3 has been changed to "Allowance" with an \$80,000 total.
6. Q: Bid Offer Form, Item No. 11, description for this item says "Asphalt Concrete Aggregate Base Course (8" minimum thickness)" but the typical section on sheet no. 14 shows 8" Aggregate Base Course. Please confirm that the intent is to have aggregate base material installed.
A: "Asphalt Concrete" has been removed from the description.
7. Q: Bid Offer Form, Item No. 12, description for this item says "Asphalt Concrete Aggregate Subbase (12" minimum thickness)" but the typical section on sheet no. 14 shows 12" Aggregate Subbase. Please confirm that the intent is to have aggregate base material installed.
A: "Asphalt Concrete" has been removed from the description.

8. Q: Bid Offer Form, Item No. 26, please confirm that the estimated quantity of 191 Cu. Yd. is correct (our takeoff amounts to only about half of the estimated quantity provided).
A: Quantity to remain unchanged.
9. Q: Bid Offer Form, Item No. 32, "Heavy equipment rental and/or costs, including delivery and hauling." Please clarify what work is covered under this item.
A: This is for any equipment that is rented or leased specific to this project. If none is rented, the cost amount should be zero.
10. Q: Bid Offer Form, Item No. 42, would the Department consider changing the \$25,000 limit for this item to a "not to exceed __% of the sum of all items" limit?
A: No.
11. Q: Bid Offer Form, Item No. 44, Field Office, including Installation and Removal - Where will the field office be set up during the project? How will the maintenance of the field office be paid? Will the Department consider increasing the allowance amount for this item? Is a field office necessary for this project?
A: The Department is currently using an existing field office for another project in the Lalamilo Development area. This existing field office will also be used for the Lalamilo Housing Phase , Kawaihae Road Improvements project. The allowance amount for this item will be used when the other project is completed. Anticipated completion of the other project is late Spring 2014. The allowance amount is set for this project.
12. Q: Bid Offer Form, Item No. 45, would the Department consider changing the \$25,000 limit for this item to a "not to exceed __% of the sum of all items" limit?
A: No.
13. Q: Bid Offer Form, Item No. 45, please clarify what is required in the "Report After Grading, including certification (as graded topographical survey and certification letter for grader)".
A: The "Report After Grading, including certification (as graded topographical survey and certification letter for grader)" is deleted from the Bid Offer Form Item 45.
14. Q: SC-26: How will the Contractor be compensated for additional work associated with encountering archaeological sites?
A: Upon verification by DHHL, the Contractor will compensated for additional work associated with encountering of archaeological sites, under Bid Offer Form Item 46, Field Directed Changes by DHHL.
15. Q: Plans sheet no. 13, detail 2, Culvert Outlet Riprap, how will the culvert outlet riprap be paid?
A: Incidental to bid Items 14 thru 17.
16. Q: Plans sheet no. 16, detail "E", Typical Guardrail Installation, how will the 1.5" A.C. Paving under the guardrail be paid?
A: Incidental to bid Item No. 8.

17. Q: Is an NPDES permit required for this project? Has the Department applied for the permit?

A: Yes and Yes.

18. Q: Please provide the Federal Davis-Bacon Wage Rate Schedule applicable to this project.

A: The Federal Wage Rate Schedule does not apply to this project because this project does not include Federal funding.

19. Q: Will a supplement to the proposal schedule for short supply materials be incorporated for this project?

A: The Department will not use the "Short Supply Materials Supplement to Proposal Schedule" as suggested. No contract amount adjustments will be made for material cost increases, except in accordance with DHHL Interim General Conditions Section 3.10.4.

**LALAMILO HOUSING PHASE 1,
KAWAIHAE ROAD IMPROVEMENTS
Pre-Bid Conference
Meeting Minutes
Thursday, May 23, 2013, 9:00 a.m. to 10:30 a.m.
Department of Hawaiian Home Lands, West Hawaii District Office**

1. Introductions:

- a. Department of Hawaiian Home Lands (DHHL)
- b. Okahara & Associates, Inc.
- c. SSFM International, Inc.

2. Scope of Work:

Channelize and widen the existing Kawaihae Road at the intersection with the Lalamilo Housing West Subdivision access road ("Keanuiomano Street"). Scope of work includes widening the existing roadway, restriping the new widened/channelized roadway, relocating affected traffic signs and utilities, and installing guardrails and roadway lighting.

3. General Requirements:

- a. Project is General Excise Tax exempt.
- b. Subject to Dept. of Labor and Industrial Relations prevailing wages and salaries. E-mail or fax Jeffrey Fujimoto questions concerning the Wage Rate Requirements.

4. Special Conditions:

- a. SC-03: Completion Schedule and Liquidated Damages
 - i. Time to complete: 240 calendar days
 - ii. Liquidated damages: \$ 750 per calendar day
- b. SC-08: Coordination with other parties (DWS, Hawaiian Telcom, HELCO, DOT, County, SIC)
- c. SC-14: Article 3: Award and Execution of Contract. Section 345: Prior to award of the contract, the Department shall verify compliance with Sections 103D and 103D-328 HRS via Hawaii Compliance Express.
- d. SC-26: Archaeological Report
- e. SC-27: Inadvertent Discovery of Human Burials.
- f. SC-37: Bond to work within State Right of Way: The Contractor shall provide separate bond and obtain a State DOT Permit to work within the Kawaihae Road State DOT Right of Way.

5. Proposal:

Hawaii Products Preference

SPO-38 **due date revised** from Monday, May 27, 2013, 2:00 pm **to Tuesday, May 28, 2013, 9:00 am.**

6. Site Access:

Construction access will be confirmed.

7. Engineer Comments:

- a. Plan Approvals. Plans included in this bid package have not been approved by all State and County agencies and are subject to change. The Successful bidder shall retain one

set of "bid set" documents for their record. An addendum will be issued to replace the current plans with Approved Construction Plans.

- b. Submit all Requests for Information (RFIs) in writing to DHHL, attn: Jeffrey Fujimoto. E-mail and fax are acceptable.
- c. Aggressive project schedule to encumber construction funds.
- d. Addenda contemplated. DHHL will issue last addendum by the end of day, Tuesday, May 28, 2013.
- e. Sandwich Isles Communication notes.

8. Deadlines:

- a. Substitution Requests – Due by **Tuesday, May 28, 2013, 9:00 am.**
- b. Hawaii Products Preference Requests SPO-38 – Due by **Tuesday, May 28, 2013, 9:00 a.m.**
- c. Intent to Bid – **Tuesday, May 28, 2013, 2:00 p.m.**
- d. Standard of Qualification Questionnaire- **Tuesday, May 28, 2013, 2:00 p.m.**
- e. Bid submittal/opening – **Friday, June 7, 2013, 2:00 p.m.**
Deliver to DHHL Hale Kalanianaʻole Building, 91-5420 Kapolei Parkway, Kapolei, Hawaii 96707, Attn: Jeffrey Fujimoto

9. Site Inspection: Following Pre-Bid Conference.

10. Questions and Answers

- 1. Q: What is the anticipated start date of the project?
A: The anticipated start of the project, subject to change, is late Summer 2013.
- 2. Q: Has DOT approved the plans yet?
A: No, DOT has not yet signed off on the plans.
- 3. Q: Bid Item 3 (Relocate Hawaiian Telcom Telephone Poles) is shown as a Lump Sum item, shouldn't it be an Allowance item?
A: This will be addressed by the Engineer in forthcoming Addendum.
- 4. Q: Bid Item 41 (Manhole relocation work by Sandwich Isles Communications) is shown as a Lump Sum item, shouldn't it be an Allowance item?
A: This will be addressed by the Engineer in forthcoming Addendum.
- 5. Q: The pdf copy of the documents has some items which are hard to read, will they be corrected?
A: Yes, they will be corrected and issued in forthcoming addendum.
- 6. Q: Item 32 (Heavy equipment rental and/or costs, including delivery and hauling) does not specify what types of equipment, can this be clarified?
A: The Engineer will clarify in forth coming Addendum.
- 7. Q: When is the existing gate shown on the Demolition Plan to be removed?
A: The removal of the existing gate shall be coordinated during construction.
- 8. Q: Is emergency egress to be provided through the gate during construction?
A: Yes, emergency egress will need to be provided.

9. Q: Items 11 (Asphalt Concrete Aggregate Base Course) and Item 12 (Asphalt Concrete Aggregate Subbase) state asphalt, does it mean Aggregate Base and Aggregate Subbase?
A. The Engineer will confirm this and advise in forthcoming Addendum.
10. Q: Some allowance items in the proposal form are missing dollar amounts. Will dollar amounts be provided?
A. The Engineer will provide the required allowance dollar amounts in forthcoming Addendum.
11. Q: Is a NPDES permit required?
A: Yes, the NPDES permit application has already been submitted.

=====

DHHL Contact: Jeffrey Fujimoto, Project Manager
Telephone: 620-9274
Fax: 620-9299
e-mail: Jeffrey.Y.Fujimoto@hawaii.gov

LALAMILO PHASE 2A, INCREMENT 1 AND KAWAIHAE ROAD IMPROVEMENTS AT SOUTH KOHALA DISTRIBUTION ROAD
PRE-BID CONFERENCE
SIGN-IN SHEET

February 28, 2012 / 11:00 a.m., DHHL West Hawaii District Office

NAME	Organization	Phone	E-mail Address
1. Jeffrey Fujimoto	DHHL, Land Development Division	620-9274	jeffrey.y.fujimoto@hawaii.gov
2. Keri Cavanagh	SSFM	747-0506	Kcavanagh@ssfm.com
3. MATTHEW WEIER	ISEMOTO CON	329-8051	SOOT @ TCCONA.COM
4. Glenn Kobayashi	Nen, Inc.	291-4234	gkobayashi@nenhawaii.com
5. Bruce Meyers	Okahara and Assoc.	961-5527	bmeyers@okahara.com
6. GENEVY YAMADA	YAMADA AND SONS, INC	937-8434	gy@yamadasons.com
7. Jim Foss	GOODFELLOW BROS	960-2330	jimf@goodfellowbros.com
8. KEVIN MURAKANE	GOODFELLOW BROS.	960-3807	KMURAKANE@goodfellowbros.com
9. 8			
10.			
11.			
12.			
13.			
14.			
15.			
16.			
17.			
18.			
19.			
20.			

The following bid is hereby submitted for _____ for the Department of Hawaiian Home Lands.

Item No.	No. of Units (Estimated)	Description	Unit Price	Unit Total
<u>ROAD RECONSTRUCTION</u>				
The price shall include reconstruction of the roadway prism, base courses, and other items as called for in the plans, including labor, tools, equipment and all incidental work necessary to construct the roadway as indicated on the plans, in place complete.				
1.	1.2	Acres, Clearing and Grubbing inclusive of proof-rolling and removal of top 6 inches of organic material. Per Acre	\$ _____	\$ _____
2.	6	Each, Remove and Relocate Existing Sign. Per Each	\$ _____	\$ _____
3.	Allowance	Relocate Hawaiian Telcom Telephone Poles (7). Contractor shall pay the Hawaiian Telcom charges for the relocation work using this allowance but shall not add construction burden, administrative charges and taxes. Used remainder of the Allowance to remain with the State. Allowance		\$80,000
4.	1	Each, Remove Existing Culvert Headwall, inclusive of removal of related posts and reflectors. Per Each	\$ _____	\$ _____
5.	1,757	Sq. Yd., Remove Existing Asphalt Concrete Pavement. Per Sq. Yd.	\$ _____	\$ _____
6.	1,030	Lin. Ft., Remove Existing Barbed Wire Fence. Per Lin. Ft.	\$ _____	\$ _____
7.	L.S.	Remove Existing Striping and Pavement Markings. Lump Sum		\$ _____
8.	985	Lin. Ft., Metal Single W-Beam Guardrail with typical 75-inch post spacing.		

		Per Lin. Ft.	\$ _____	\$ _____
9.	3	Each, Guardrail SKT-350 end treatment.		
		Per Each	\$ _____	\$ _____
10.	807	Ton, Hot Mix Asphalt Concrete Pavement, State Mix No. IV (4" minimum thickness).		
		Per Ton	\$ _____	\$ _____
11.	1,537	Ton, Aggregate Base Course (8" minimum thickness).		
		Per Ton	\$ _____	\$ _____
12.	2,305	Ton, Aggregate Subbase (12" minimum thickness).		
		Per Ton	\$ _____	\$ _____
13.	1,872	Cu. Yd., Excavation (including embankment) inclusive of hauling, placing and compacting.		
		Per Cu. Yd.	\$ _____	\$ _____
14.	45	Lin. Ft., 24" Reinforced Concrete Drain Pipe inclusive of trench excavation, pipe cushion and backfill.		
		Per Lin. Ft.	\$ _____	\$ _____
15.	3	Cu. Yd., Cement Rubble Masonry (CRM) Apron, in-place complete.		
		Per Cu. Yd.	\$ _____	\$ _____
16.	1	Each, Concrete Headwall.		
		Per Each	\$ _____	\$ _____
17.	1	Each, Connection to Existing 24" Drainline inclusive of furnishing and installing of all necessary materials and appurtenances (excluding excavation and trenching work).		
		Per Each	\$ _____	\$ _____
18.	7	Each, Pavement Arrow Marking.		
		Per Each	\$ _____	\$ _____
19.	8	Each, Pavement Word Marking.		
		Per Each	\$ _____	\$ _____

20.	1	Each, Yield Line Marking. Per Each	\$ _____	\$ _____
21.	195	Each, Raised Pavement Markers. Per Each	\$ _____	\$ _____
22.	5,680	Lin. Ft., 4-Inch Pavement Striping (Thermoplastic Extrusion). Per Lin. Ft.	\$ _____	\$ _____
23.	155	Lin. Ft., 8-Inch Pavement Striping (Thermoplastic Extrusion). Per Lin. Ft.	\$ _____	\$ _____
24.	240	Lin. Ft., 12-Inch Pavement Striping (Thermoplastic Extrusion). Per Lin. Ft.	\$ _____	\$ _____
25.	8	Each, Traffic Sign with Post, in-place complete. Per Each	\$ _____	\$ _____
26.	191	Cu. Yd., Placed Riprap for reconstructed swale, in-place complete. Per Cu. Yd.	\$ _____	\$ _____
27.	L.S.	Erosion Control (inclusive of, but not limited to, silt fence, sediment filter, rye grassing). Lump Sum		\$ _____
28.	L.S.	Temporary Traffic Control Measures. Lump Sum		\$ _____
TOTAL – ROADWAY RECONSTRUCTION (Items 1 to 28 Inclusive)				\$ _____
<u>UNDERGROUND ELECTRIC AND AREA LIGHTING SYSTEMS</u>				
The prices bid herein for the following items shall include all labor, tools, equipment and materials, except that to be supplied by the Utility Companies, appurtenances and incidentals necessary to install or to construct the following items in place and complete in accordance with the drawings and specifications and standard practices of Hawaii Electric & Light Company (HELCO), Sandwich Isles Communication, Inc. (SIC) and to the satisfaction of the DHHL.				

29.	L.S.	Mobilization; demobilization; field investigations and measurements; hauling, clean-up and finishing. Lump Sum		\$_____
30.	L.S.	Demolition/Removal/Relocation/Restoration work for existing Fiber Optics Cable. Lump Sum		\$_____
31.	220	Lin. Ft., Trenching, excavation, backfill, for underground ductlines, all per serving utility standards and requirements, approx minimum 30 inch wide by 48 inch deep or as required for 1 or 2 conduit ductbank. Per Lin. Ft.	\$_____	\$_____
32.	L.S.	Heavy equipment rental and/or costs, including delivery and hauling. Lump Sum		\$_____
33.	L.S.	Work within existing public right-of-way for repairs to existing pavements, shoulders, swales, curbs, grassed area, driveway, and incidental work, all in accordance with Highways Division, Department of Transportation standards and requirements. Lump Sum		\$_____
34.	20	Cu. Yd., Minimum concrete encasement for underground conduits and cables, including temporary and/or permanent form work as required, in place, complete, and in accordance with serving utility standards and requirements. Per Cu. Yd.	\$_____	\$_____
35.	200	Lin. Ft., "Warning" tape for underground ductline, 4-inch wide, as specified, in place, complete, in accordance with serving utility standards and requirements. Per Lin. Ft.	\$_____	\$_____
36.	190	Lin. Ft., SCH 40 PVC, 4 inch conduits for use by utility companies, in place, complete, including connections to manholes where required, swabbed		













		cleaned of burrs and foreign material, with pull lines, all in accordance with serving utility standards and requirements. Per Lin. Ft.	\$_____	\$_____
37.	2	Each, Communications (COMM/UM 4x6) manhole and cover, including all required excavation and backfill, concrete work, and conduit termination, in place, complete, with ground rod, and as acceptable to serving COMM company. Per Each	\$_____	\$_____
38.	2	Each, Roadway Lighting Standard, Type 2, luminaire and accessories, including concrete foundation, ground rod, and conduit stub-out from foundation, in place, complete, and in accordance with County of Hawaii's requirements. Per Each	\$_____	\$_____
39.	290	Lin. Ft., Wiring for Roadway Lighting Standards, including conduits, conductors, required trenching, excavation, backfill, cushion material, "warning tape", and concrete encasement. Per Lin. Ft.	\$_____	\$_____
40.	L.S.	Energization and testing of all Lighting Standards. Lump Sum		\$_____
41.	Allowance	Adjust manhole cover for Sandwich Isles Communications manhole to match finish elevation of new roadway. Allowance		\$15,000
TOTAL – UNDERGROUND ELECTRIC AND AREA LIGHTING SYSTEMS (Items 29 to 41 Inclusive)				\$_____
<u>MISCELLANEOUS</u> The price for the following items shall include all labor, tools, equipment, material and incidentals necessary to construct the following items, in place complete.				
42.	L.S.	Mobilization, including Obtaining Insurance, Bonds, Permits, Scheduling, Submittal, and Other		

		Activities to Mobilize for Project. Maximum \$25,000.		
		Lump Sum		\$_____
43.	L.S.	Project Sign, in place complete.		
		Lump Sum		\$_____
44.	Allowance	Field Office, including Installation and Removal.		
		Allowance		\$ <u>25,000</u>
45.	L.S.	Demobilization, including Removing Excess Materials, and Equipment, Clean-up, Report After Grading, including certification (as graded topographical survey and certification letter for grader). Maximum \$25,000.		
		Lump Sum		\$_____
46.	Allowance	Field Directed Changes by DHHL.		
		Allowance		\$ <u>300,000</u>
47.	Allowance	Hiring of Geotechnical Engineer for necessary field observations, laboratory testing, etc.		
		Allowance		\$ <u>30,000</u>
TOTAL – MISCELLANEOUS (Items 42 to 47 Inclusive)				\$_____
TOTAL SUM BID (EXCLUDING GET) (Items 1 to 47 Inclusive)				\$_____

TOTAL SUM BID = _____ Dollars(\$_____).

The prices herein for the above items shall include all materials, labor, tools, equipment, machinery and all incidentals necessary, exclusive of general excise tax to install or to construct these items in place complete and in accordance with the plans and specifications contained in this IFB.

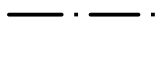

	NEW MAJOR CONTOUR
	NEW MINOR CONTOUR
	EXIST. RIGHT-OF-WAY
	EXIST. MAJOR CONTOUR
	EXIST. MINOR CONTOUR
	SAWCUT LINE
	NEW CLEAR ZONE
	GUARDRAIL
	LIMITS OF GRADING
	SILT FENCE
	HIGHWAY IMPROVEMENT EASEMENT
	DRAINAGE EASEMENT
	NEW A.C. PAVEMENT

	GUARDRAIL
C#	STATION/OFFSET LABEL
L#	SEE SHEET C-11
PSHD	CURVE NUMBER
USHD	LINE NUMBER
TRAV	A.C. PAVED SHOULDER
STOR	UNPAVED SHOULDER
STRP MED	TRAVEL
KB	STORAGE
WB	STRIPED MEDIAN
	KAWIAHAE BOUND
	WAIMAE BOUND

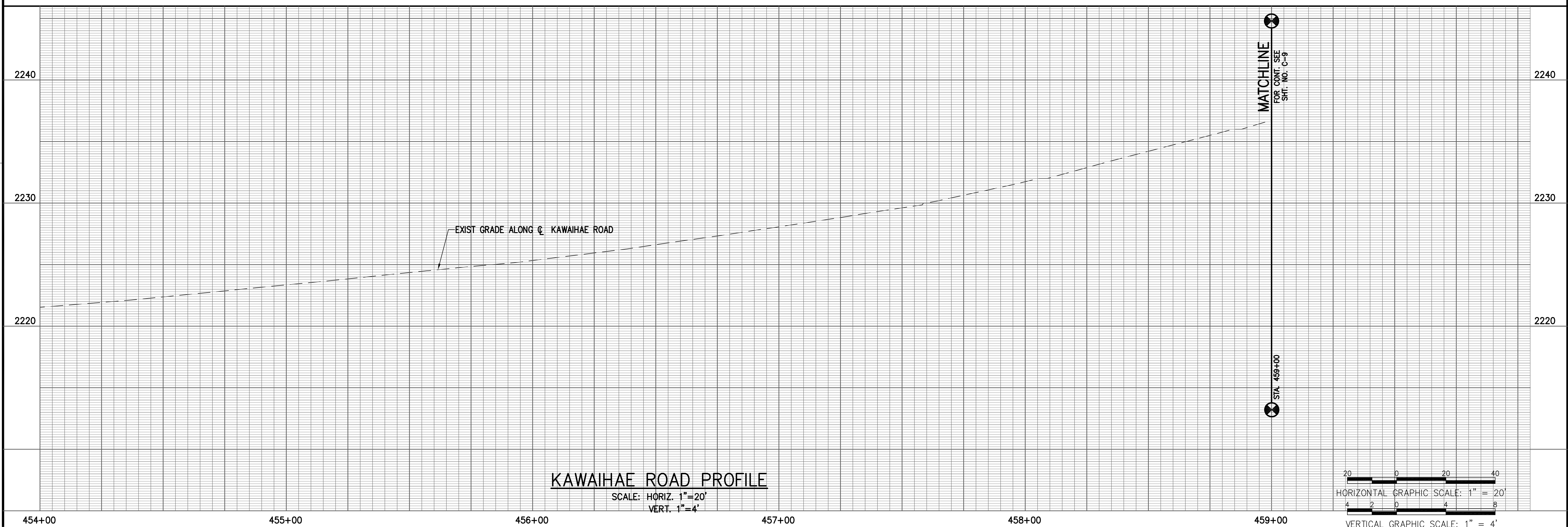

MICROBIA

WIN CLIK

DAIL

NO.

Okahara and Associates Inc.
CONSULTING ENGINEERS



LALAMILO HOUSING PHASE 1
KAWAIHAE RD. IMPROVEMENTS
PLAN AND PROFILE-KAWAIHAE ROAD
STA. 454+10 TO 459+00
DATE: MAY 2013

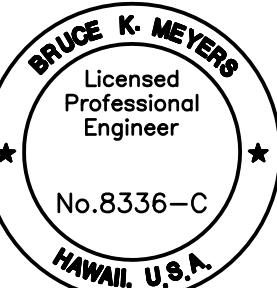

THIS WORK WAS PREPARED BY ME OR UNDER
MY SUPERVISION AND CONSTRUCTION OF THIS
PROJECT WILL BE UNDER MY OBSERVATION

Bruce Dreyer

APR 30 2014

DRAWN BY: MHD/SS
DESIGNED BY: MTY/MHD
CHECKED BY: BKM

DRAWING NO.

C-8

SHEET NO.

9

REVISION



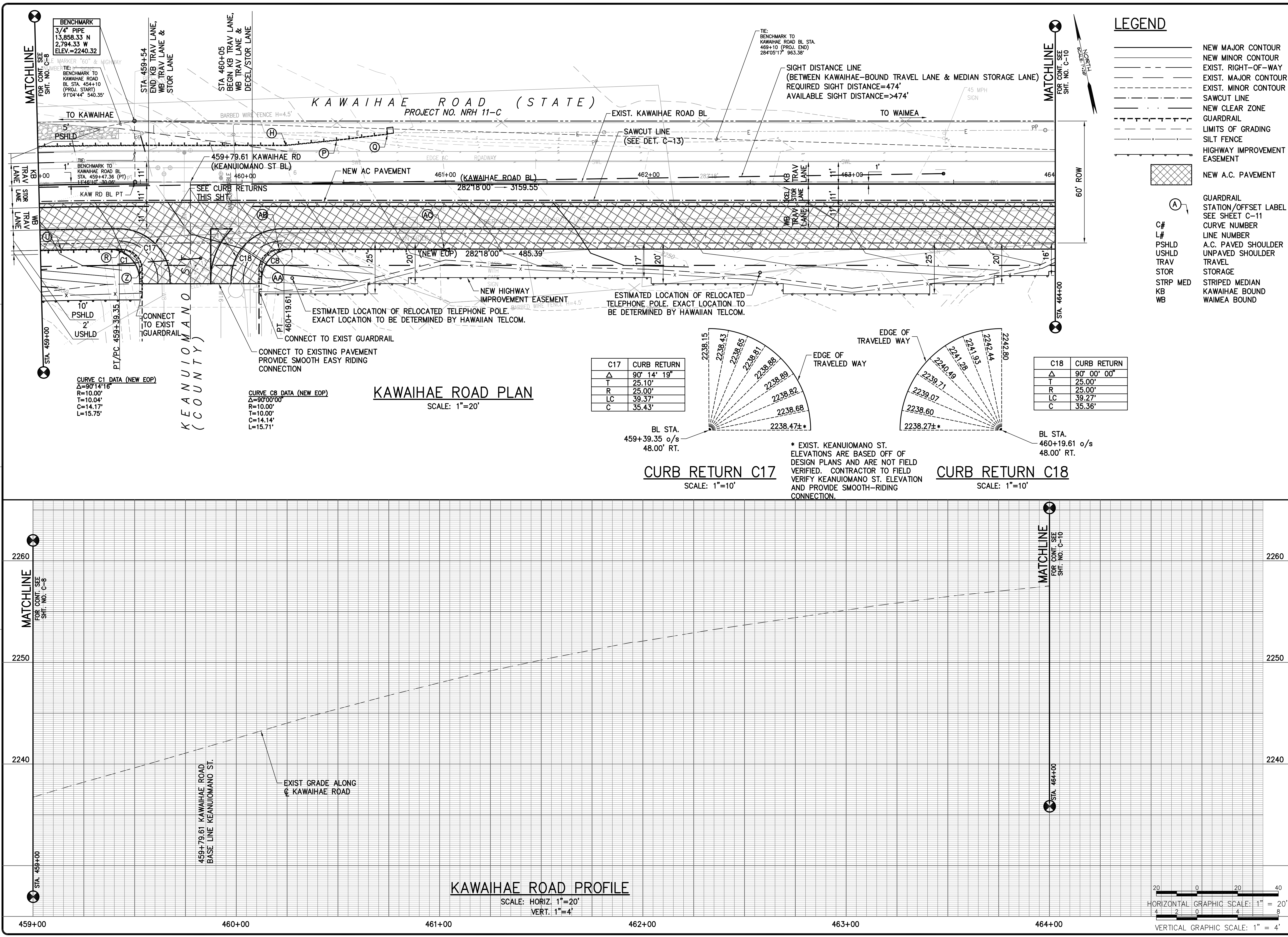

REVISION

DATE

DWN

CHK

NO.

Okahara and Associates Inc.

CONSULTING ENGINEERS

200 KOKOLA STREET
HILLO, HAWAII 96720
TEL. (808) 961-5527

LALAMLO HOUSING PHASE 1

KAWAIHAE RD. IMPROVEMENTS

PLAN AND PROFILE-KAWAIHAE ROAD
STA. 459+00 TO 464+00
DATE: MAY 2013

BRUCE K. MEYERS

Licensed Professional Engineer

No. 8336-C

HAWAII, U.S.A.

THIS WORK WAS PREPARED BY ME OR UNDER MY SUPERVISION AND CONSTRUCTION OF THIS PROJECT WILL BE UNDER MY OBSERVATION

Bruce K. Meyers

EXP. DATE APR 30, 2014

DRAWN BY: MHD/SS

DESIGNED BY: MTY/MHD

CHECKED BY: BKM

DRAWING NO.

C-9

SHEET NO.

10

REVISION

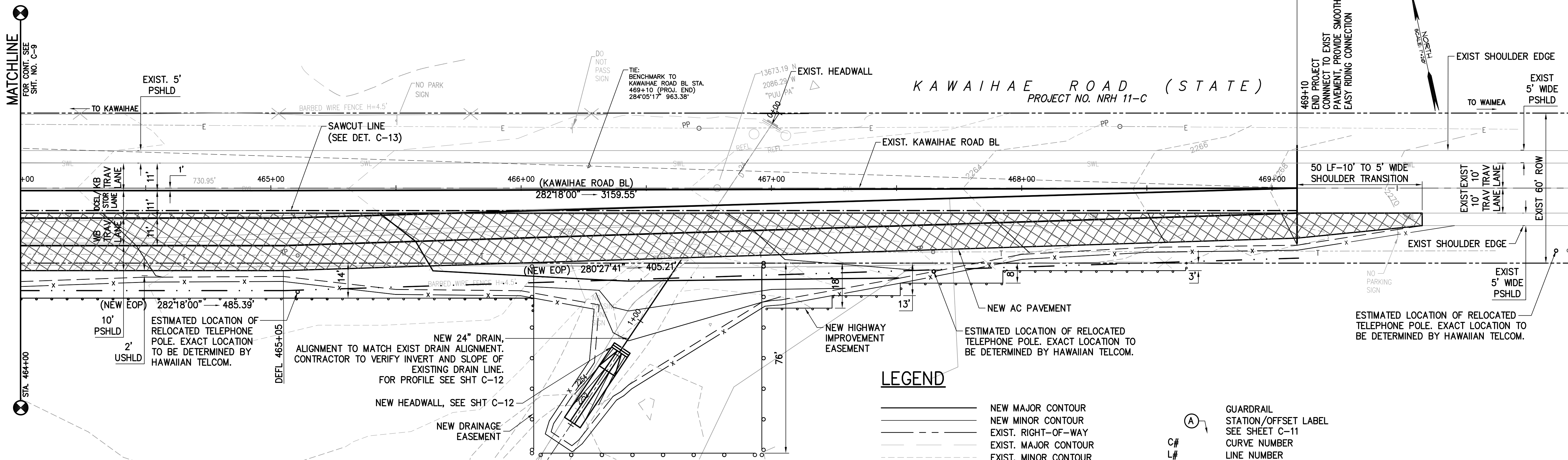

KAWAIHAE ROAD PLAN
SCALE: 1"=20'

LEGEND

- | | | | |
|---------------|------------------------------|-----|----------------------|
| — | NEW MAJOR CONTOUR | (A) | GUARDRAIL |
| - - - | NEW MINOR CONTOUR | | STATION/OFFSET LABEL |
| - . - . - | EXIST. RIGHT-OF-WAY | | SEE SHEET C-11 |
| - - - | EXIST. MAJOR CONTOUR | | CURVE NUMBER |
| - . - . - | EXIST. MINOR CONTOUR | | LINE NUMBER |
| - - - | SAWCUT LINE | | A.C. PAVED SHOULDER |
| - - - | NEW CLEAR ZONE | | UNPAVED SHOULDER |
| - - - | GUARDRAIL | | TRAVEL |
| - - - | LIMITS OF GRADING | | STORAGE |
| - - - | SILT FENCE | | STRIPED MEDIAN |
| - - - | HIGHWAY IMPROVEMENT EASEMENT | | KAWAIHAE BOUND |
| - - - | DRAINAGE EASEMENT | | WAIMEA BOUND |
| [Hatched Box] | NEW A.C. PAVEMENT | | |

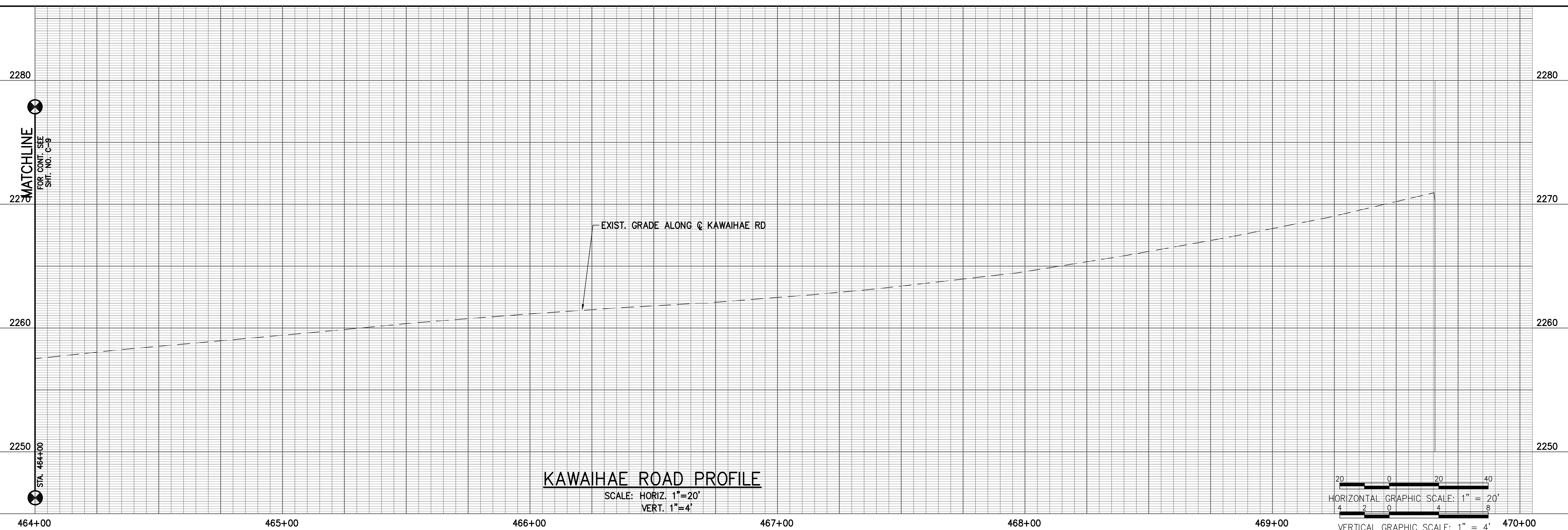

KAWAIHAE ROAD PROFILE
SCALE: HORIZ. 1"=20'
VERT. 1"=4'

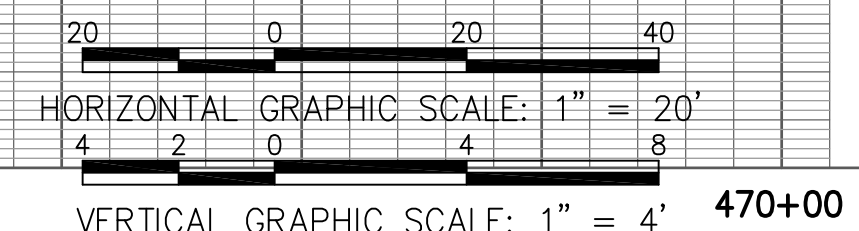

REVISION
DATE
DWN
CHK
NO.

Okahara and Associates Inc.
CONSULTING ENGINEERS
200 KOKOLA STREET
HILO, HAWAII 96720
TEL. (808) 961-5527



LALAMILO HOUSING PHASE 1
KAWAIHAE RD. IMPROVEMENTS
PLAN AND PROFILE-KAWAIHAE ROAD
STA. 464+00 TO 469+10
DATE: MAY 2013

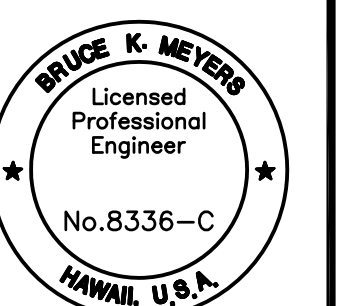

THIS WORK WAS PREPARED BY ME OR UNDER MY SUPERVISION AND CONSTRUCTION OF THIS PROJECT WILL BE UNDER MY OBSERVATION.
Bruce K. Meyers
EXP. DATE: APR 30, 2014
DRAWN BY: MHD/SS
DESIGNED BY: MTY/MHD
CHECKED BY: BKM

DRAWING NO.
C-10

SHEET NO.
11

REVISION
[Triangle]

KAWAIHAE ROAD BL STA. 466+63.9± o/s 28.7'± RT.
DRAINLINE STA. 0+70.6±
CONNECT TO EXIST.
24" DRAINLINE
INV=2254.1±***

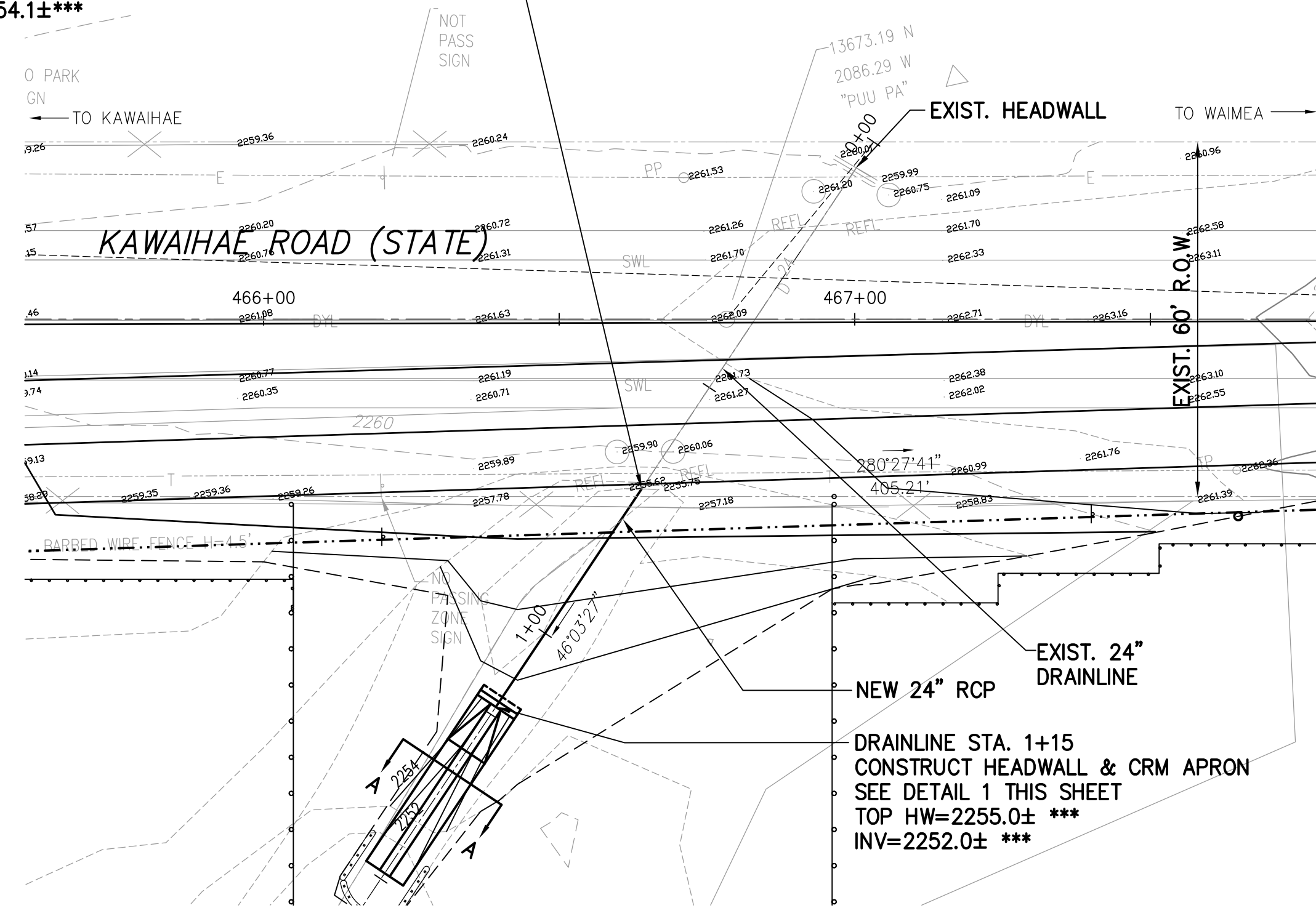

DRAINLINE PLAN
SCALE: 1"=20'

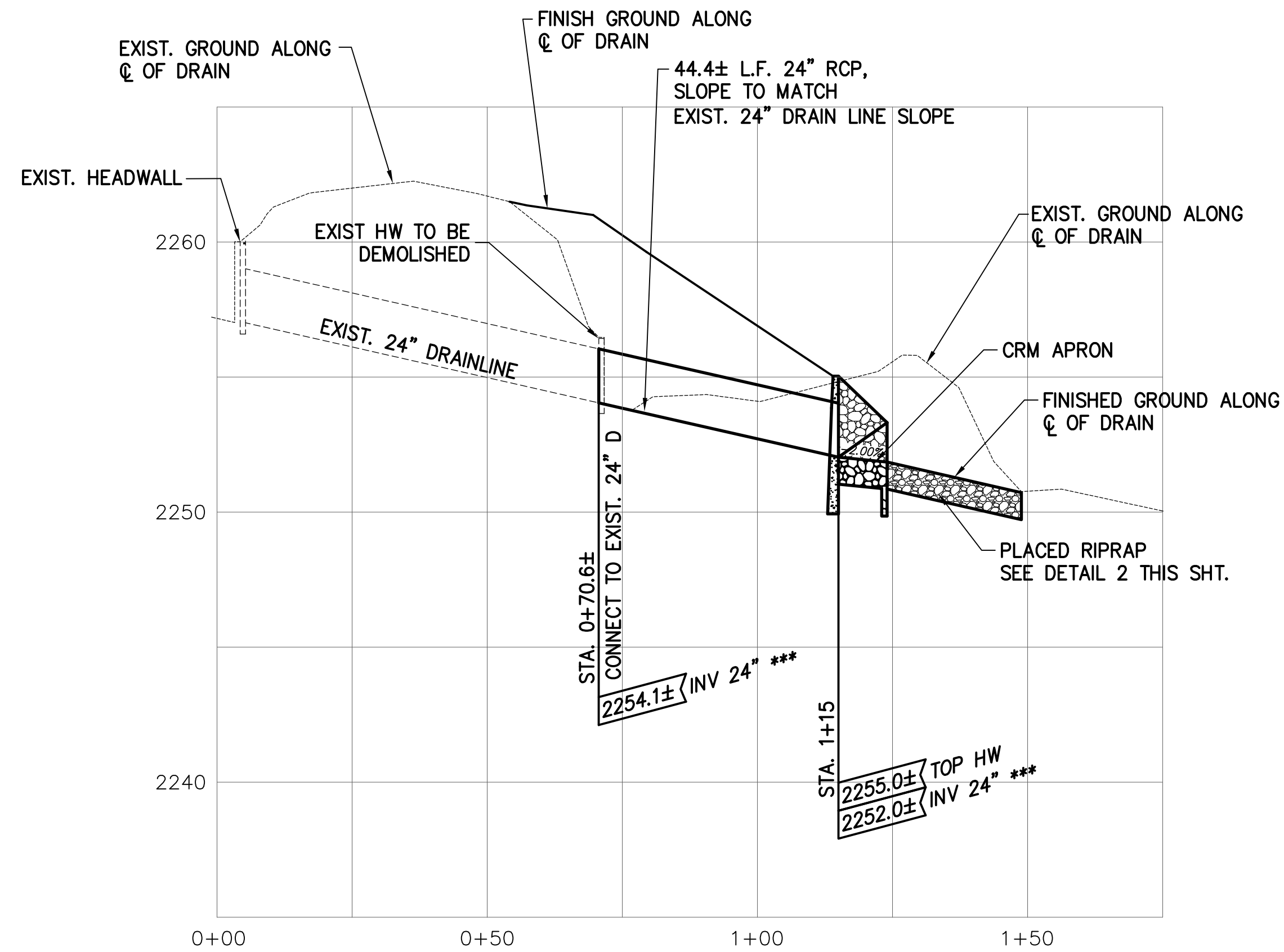

NOTE:
*** CONTRACTOR TO VERIFY SLOPE AND INVERT OF EXISTING 24" DRAIN LINE

DRAINLINE PROFILE
SCALE: HORIZ. 1"=20'
VERT. 1"=4'

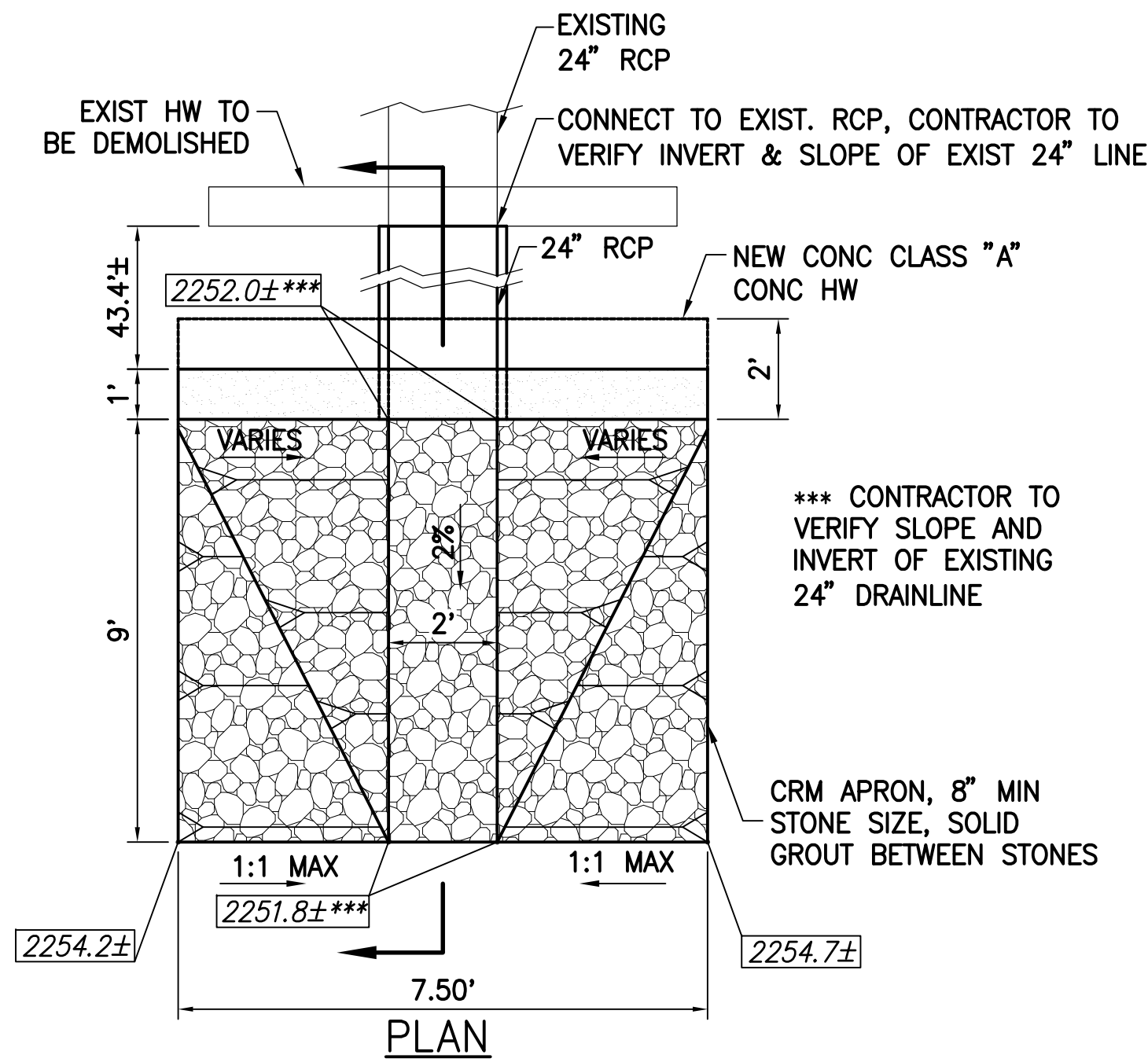

2 SECTION A-A: CULVERT OUTLET RIPRAP
SCALE: 1/2"=1'-0"

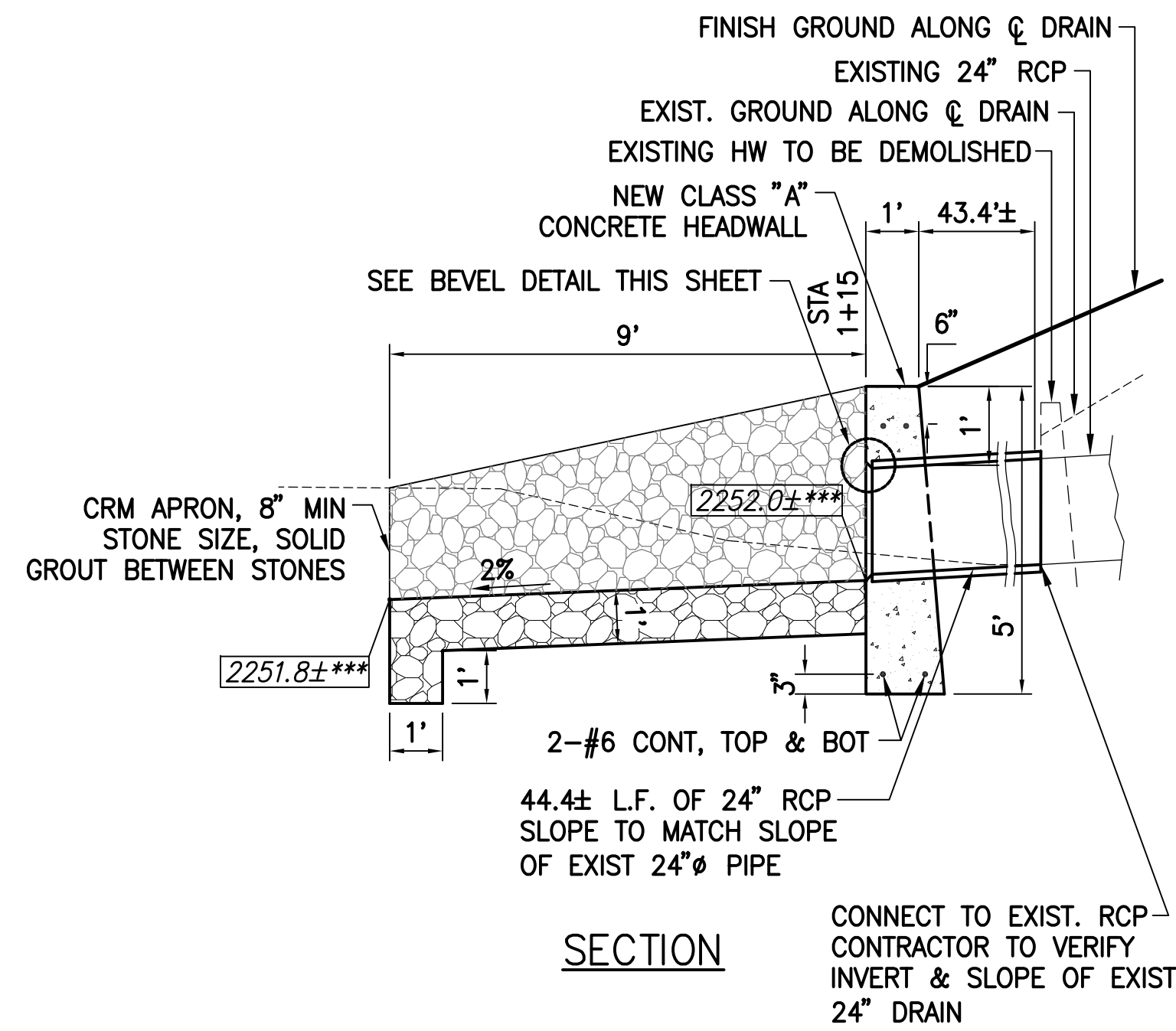

SECTION

GENERAL NOTES:
1. THE GROOVE OR BELL END OF THE CONCRETE CULVERT MAY BE USED IN PLACE OF THE BEVEL.

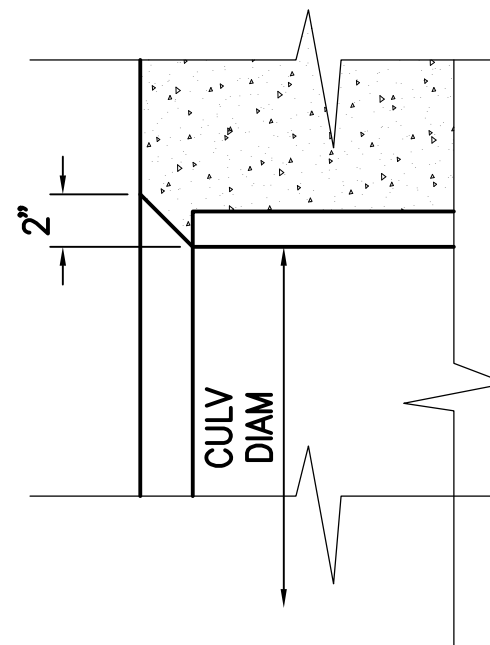

BEVEL DETAIL

3 TYPICAL PIPE TRENCH DETAIL
N.T.S.

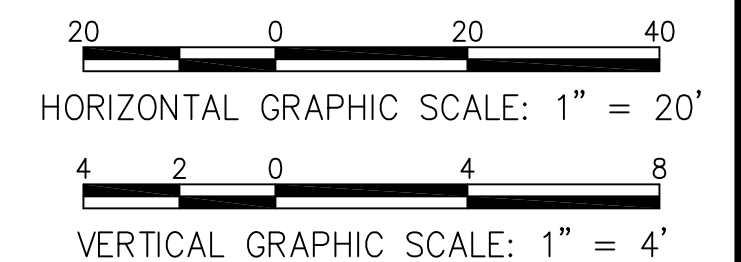
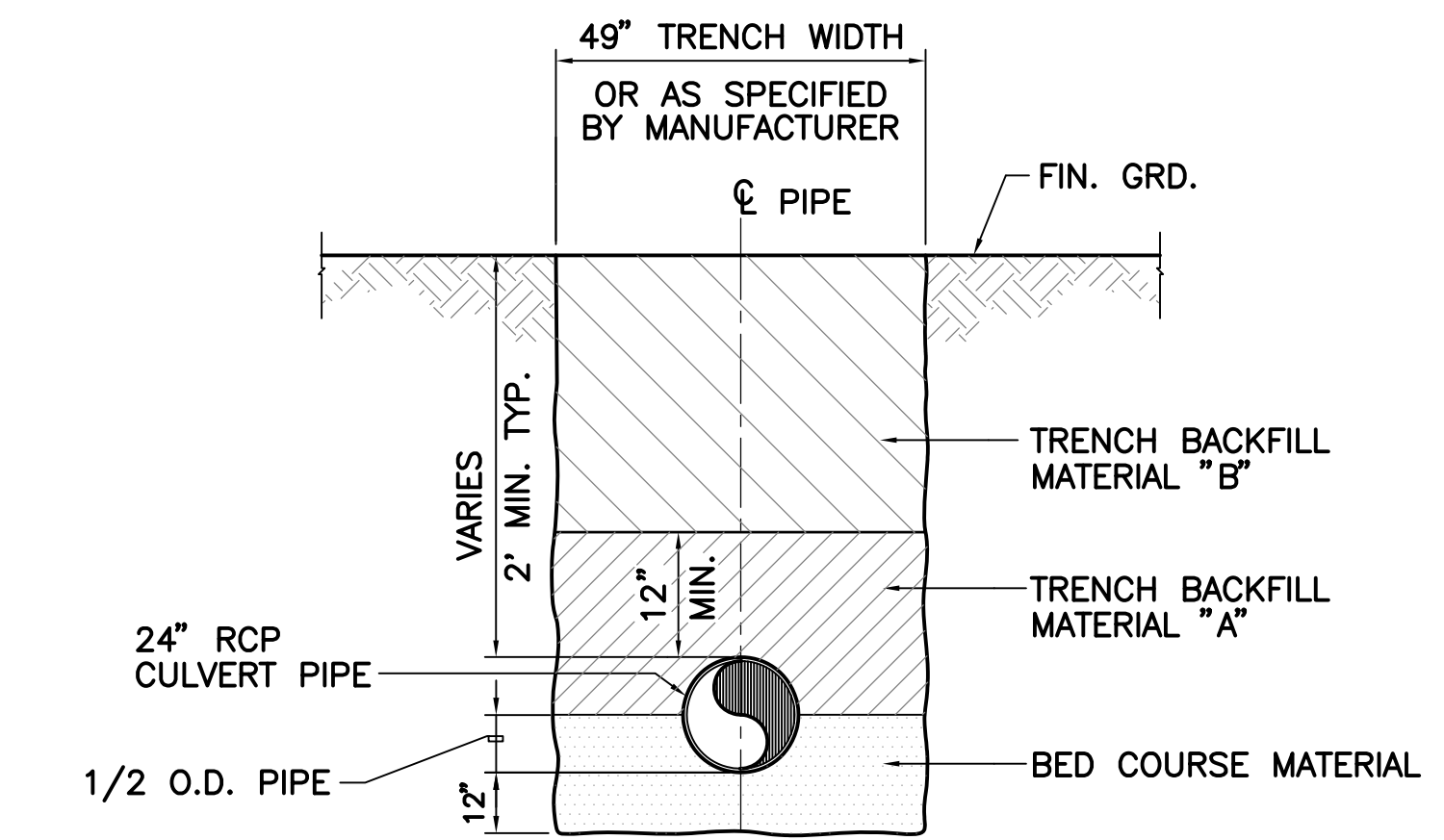

1 HEADWALL DETAIL
N.T.S.

REVISION

DWN CHK

DATE

NO.

Okahara and Associates Inc.
CONSULTING ENGINEERS
200 KOHOLA STREET
HILO, HAWAII 96720
TEL. (808) 961-5527

LALAMLO HOUSING PHASE 1
KAWAIHAE RD. IMPROVEMENTS
PLAN AND PROFILE -
DRAINLINE
DATE: MAY 2013

BRUCE K. MEYERS
Licensed Professional Engineer
No. 8336-C
HAWAII, U.S.A.

THIS WORK WAS PREPARED BY ME OR UNDER MY SUPERVISION AND CONSTRUCTION OF THIS PROJECT WILL BE UNDER MY OBSERVATION
EXP. DATE APR 30, 2014

DRAWN BY: MHD/SS
DESIGNED BY: MTY/MHD
CHECKED BY: BKM

DRAWING NO.
C-12

SHEET NO.
13

REVISION
△